

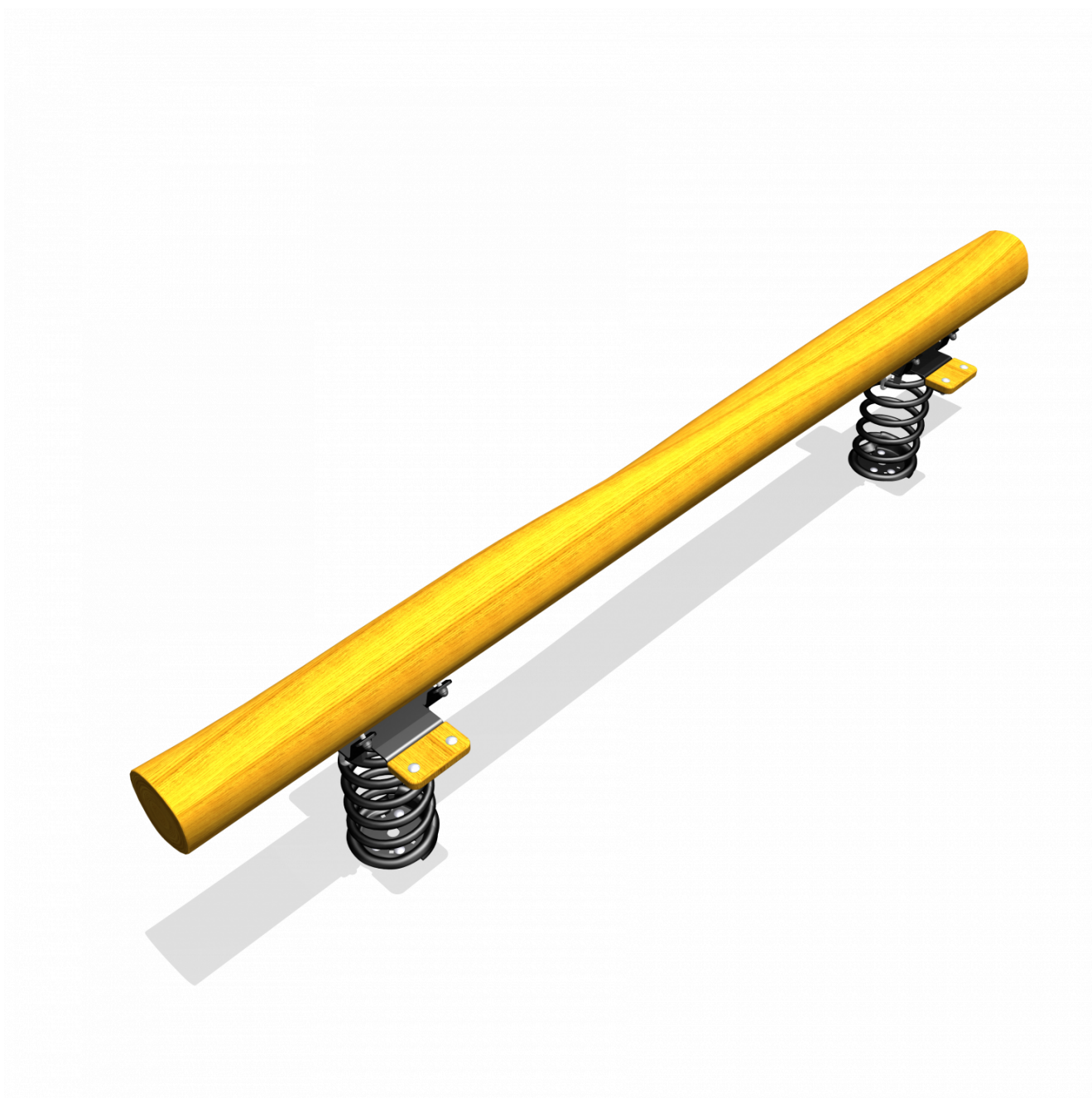

Springer beam

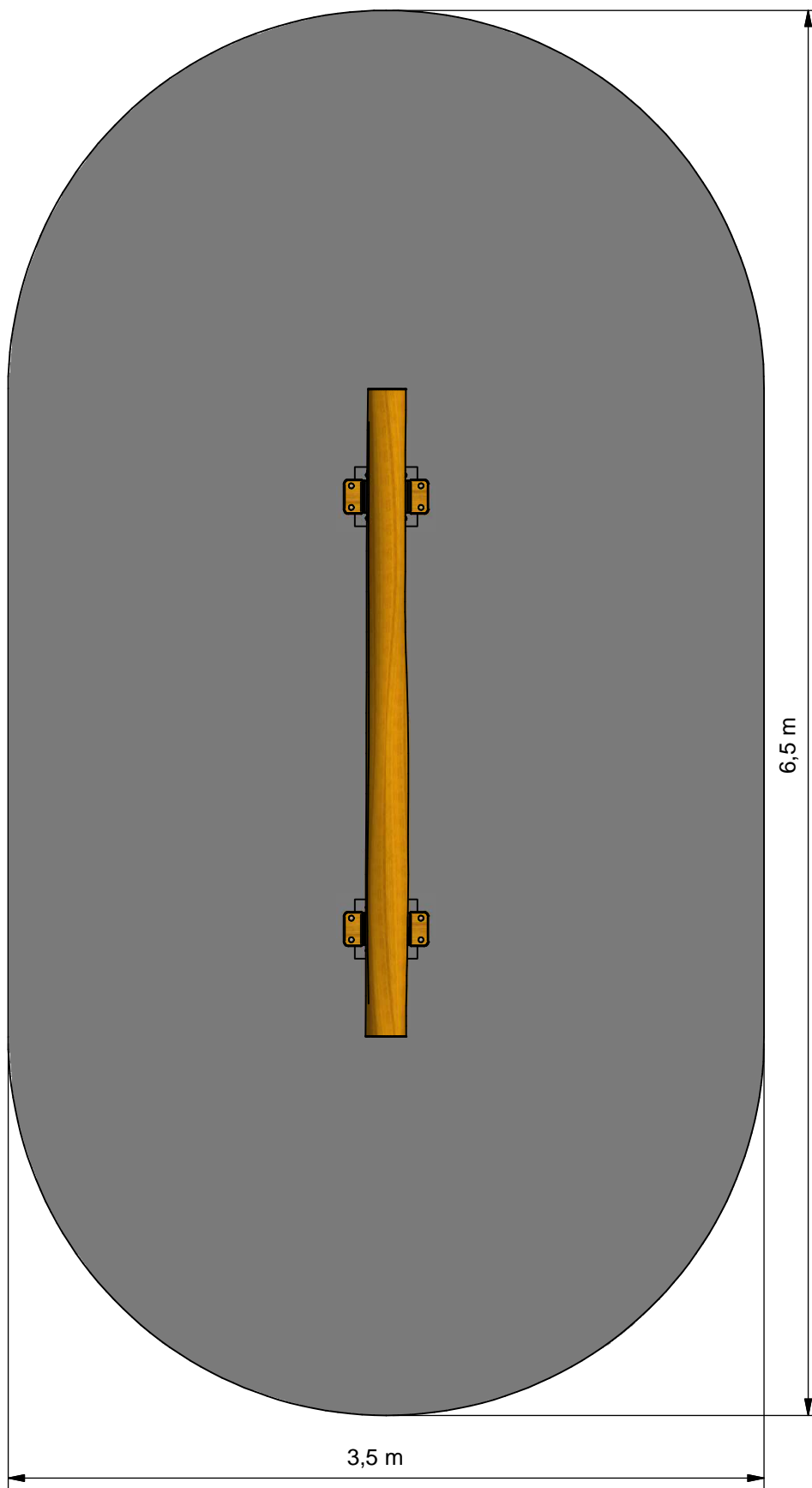

PSTE000.145



6,5 m

3,5 m

- Opvangzone
Impact area
- Obstakelvrije zone
Obstacle free zone



Benaming
Title Veerbalk

Opmerking
Comment Adventure Play

Datum
Date 19-12-2011

Tekening
Drawing

TOE PST 000 145

Obstakelvrije zone *Obstacle free zone*

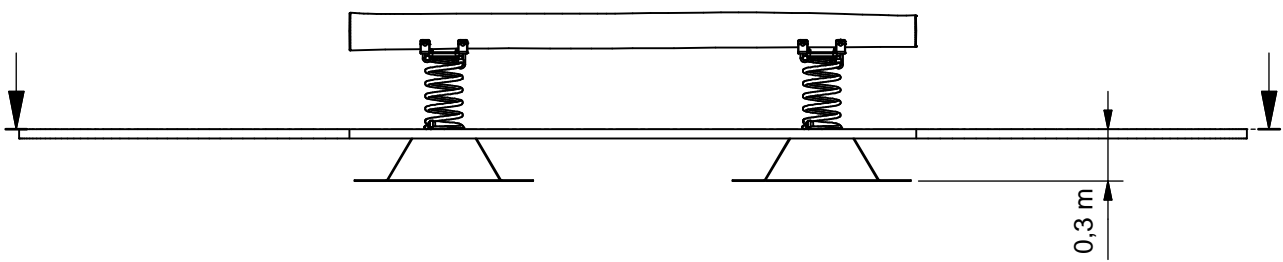
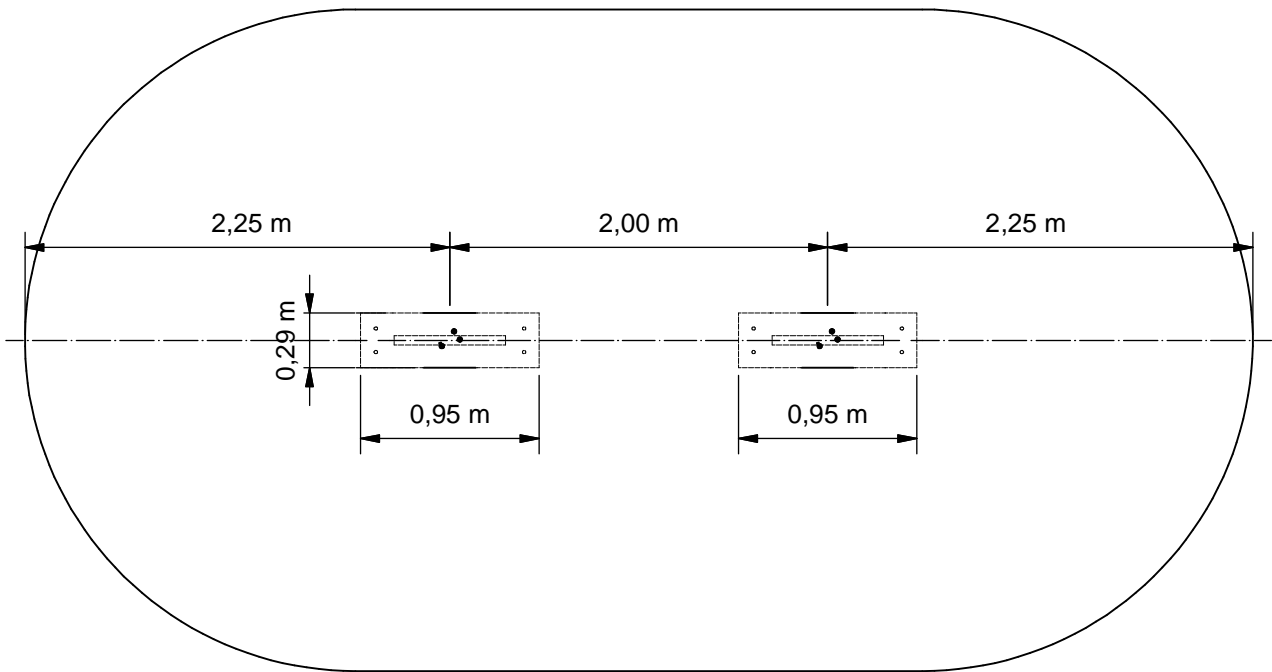

Benaming
 Title Veerbalk
 Opmerking
 Comment Adventure Play
 Datum
 Date 19-12-2011

Tekening
 Drawing

TOE PST 000 145

Bodemplan *Groundplan*

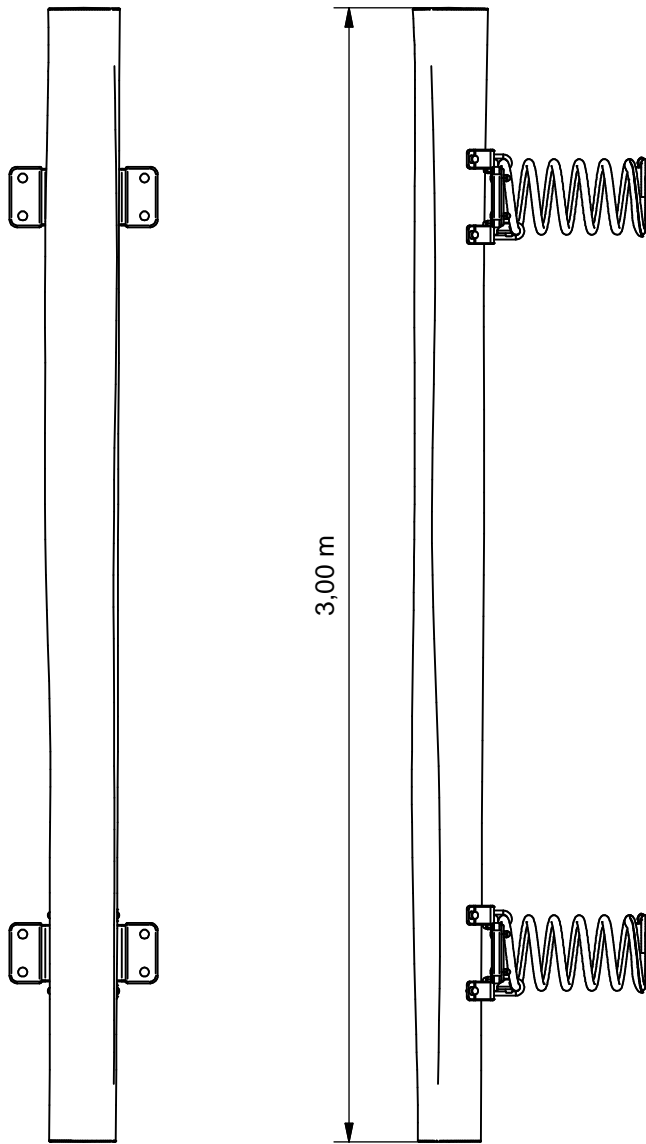

B-B (1:5)

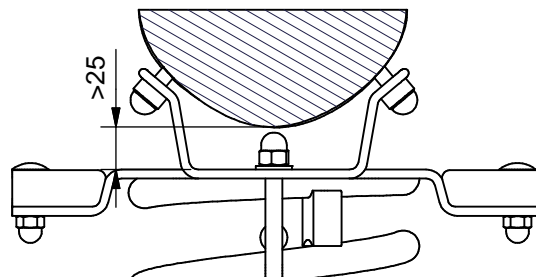
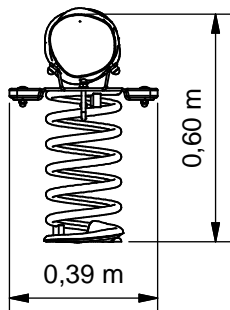

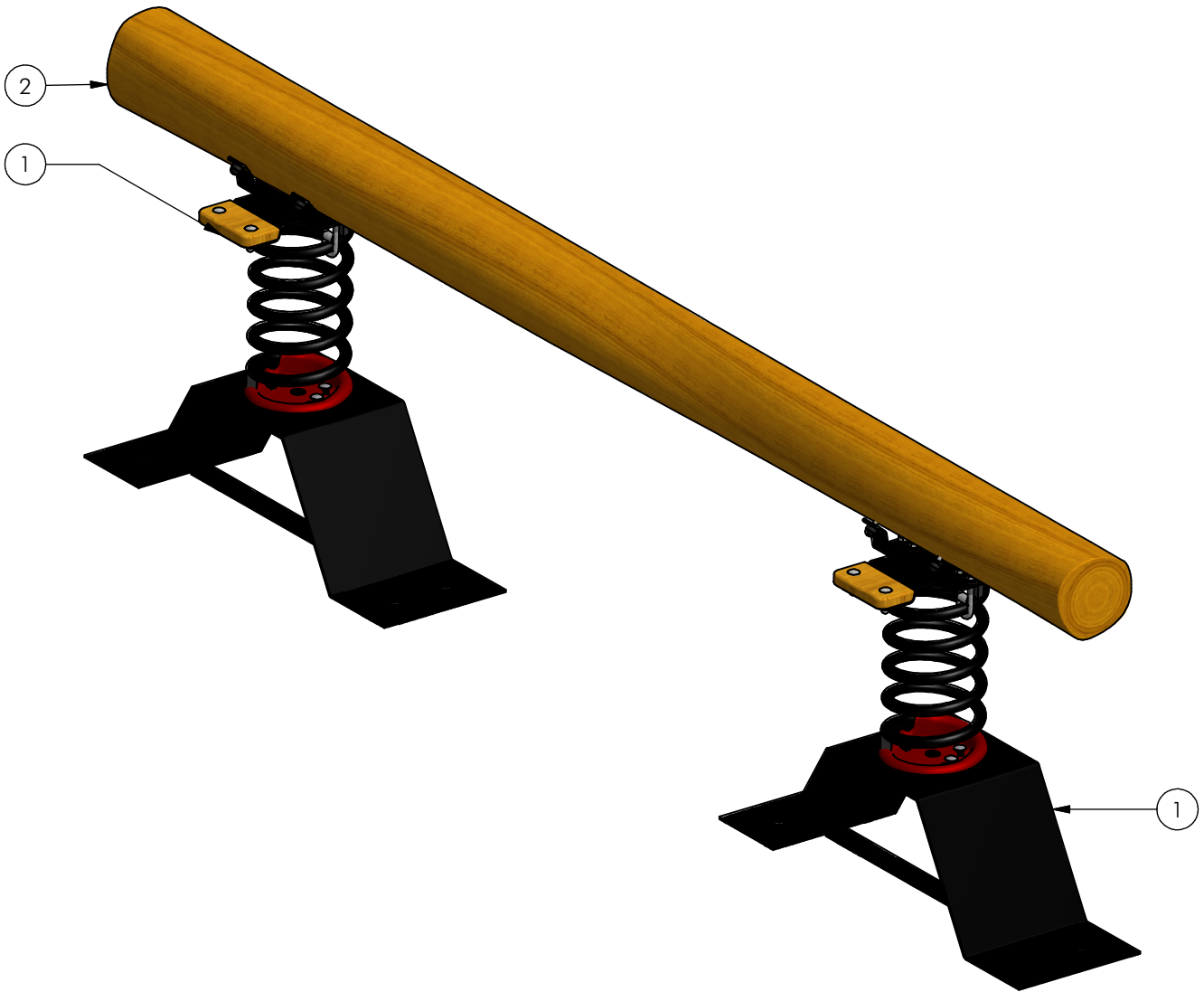

2	1	MOD	PST	006	031		Veerbalk	Adventure Play
1	2	MOD	PST	006	029		Veerstier	Onderstel
Nr	#	Type	Progr.	Volgnr	Bew.	Rev	Benaming	Opmerking



Benaming
Title | Veerbalk

Opmerking
Comment | Adventure Play

Datum
Date | 19-12-2011

Tekening
Drawing

TOE PST 000 145

Modules Modules

Geleverde delen:

A - veerelement met onderstel

Bevestiging sets:

1 - n.v.t.

Montagevolgorde:

- 1 - graaf de gaten volgens het bodemplan en plaats hierin het toestel
- 2 - controleer of het toestel voldoet aan de afmetingen zoals op blad 'afmetingen'
- 3 - dicht de gaten en verdicht het zand

Controles:

- 1 - correcte opbouw en alle bevestigingsmiddelen
- 2 - controleer de afmetingen van de valbodem t.o.v. het toestel

Supplied parts:

A - rocking-element with support

Mounting kits:

1 - n.a.

Assembly sequence:

- 1 - dig the holes according to the ground plan and place the play equipment
- 2 - check that the equipment conforms to the dimensions shown on sheet 'dimensions'
- 3 - close the holes and compact the sand

Checks:

- 1 - correct assembly and all the fasteners
- 2 - check the dimensions of the safety area compared to the play equipment

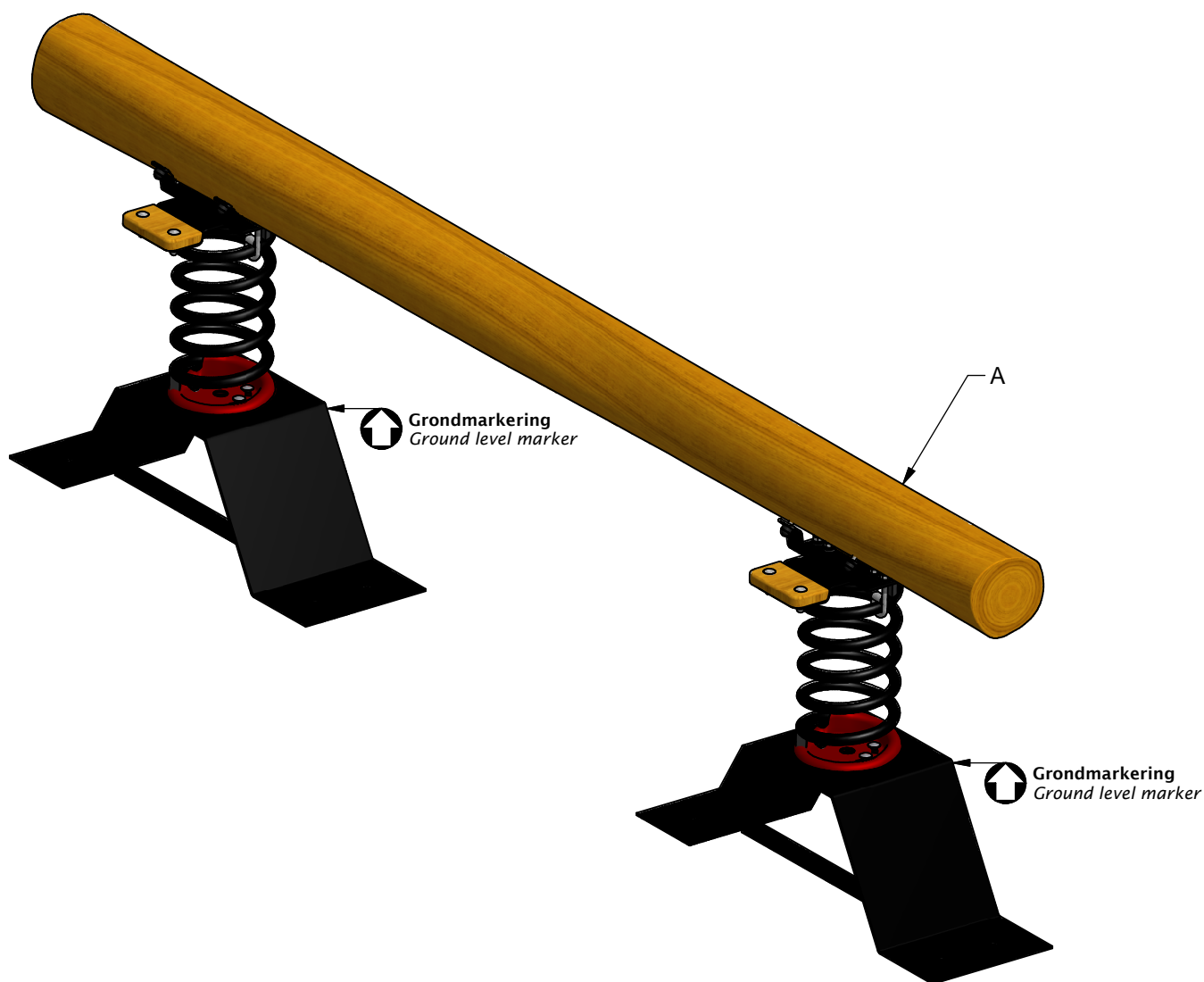

PSTE000.145

Springer beam

LOGBOOK

(Onderstaand logboek kan gebruikt worden om te voldoen aan de eisen, gesteld in artikel 14 van het Warenwetbesluit Attractie- en Speeltoestellen)

Type indication	Adventure Play
Product code	PSTE000.145
Name of equipment	Veeerbalk
Maximum height of fall	0,6 m
Year of construction	2017
Certificate	032684
inspection authority	TUV Nederland QA BV De Waal 21c, Best - 5684 PH Best
Name manufacturer	BOERplay Hyacintstraat 2 - 4255 HX Nieuwendijk Phone: +31 (0)183 40 23 66 Fax: +31 (0)183 40 35 64
name installer	_____ _____
Description of equipment	Springer beam
Location of equipment	_____
Data about the owner of the play equipment	
Name:	_____
Address:	_____
Postcode and town:	_____
Contact person:	_____
Telephone number:	_____
Data about the administrator of the play equipment	
Name:	_____
Address:	_____
Postcode and town:	_____
Contact person:	_____
Telephone number:	_____

LOGBOOK

Inspection and maintenance intervals



Nr.	Inspection	Maintenance	months between inspections
1	Verify equipment's stability, junctions and missing parts. Inspect bolts, screws and nuts for absence, jams, corrosion and wear.	Add missing parts, secure joints, apply missing fixing agent and replace corroded parts.	1
2	Check suspension for wear.	Replace worn parts and/or remove non-functioning parts.	1
3	Inspect rotating parts such as hinges, rolling-element bearings, etc. for wear and acceptability.	Replace worn parts and/or remove non-functioning parts.	1
4	Check wood for splinters, unacceptable damage and signs of rot. Especially at ground level.	Repair damage. Replace affected wood. Smoothen splintered wood and sharp edges.	1
5	Inspect foundation for stability, tearing and coverage.	Restore foundation and covering material.	3
6	Examine rubber and synthetic parts for wear, damage and break.	Replace original parts.	3
7	Inspect metal for corrosion and damage in the coating.	Restore any damaged coating (after removing rust and applying primer).	6
8	Check ropes, cables, chains and nets for wear and damage. Steel cables and nets which are tensioned must be checked for tension.	Replace parts where necessary. Steel cables and nets must be tensioned.	3
9	Inspect equipment for unsafe changes and additions.	Remove unsafe additions and correct unsafe changes.	1
10	Inspect safety surfaces.	Restore and repair where necessary.	1

Remarks

1. If used intensively, all points require extra attention.
2. Extreme weather conditions and locations may require a higher inspection frequency. Discuss this with the supplier.
3. Vandalism-sensitive locations require stricter inspections, possibly daily.
4. Check the terrain regularly for items that do not belong there, are unsafe or may be used wrongly. Examples are poisonous plants, glass shards, etc. Frequency depends on strain.
5. Remember that bad maintenance leads to unsafe conditions and notably faster impoverishment of the playground area.
6. Replacement parts can be ordered at the manufacturer with the part numbers on the module drawing. Drawings can be found in de user guide.
7. The impact area shall be provided with impact attenuating surface according to the specified falling height.
8. This list is conform the CEN-standard "playground equipment and surfacing NEN-EN 1176-7".

Warenwet

Certificaat van Typeonderzoek Type Examination Certificate

afgegeven door issued by

TÜV Nederland QA BV

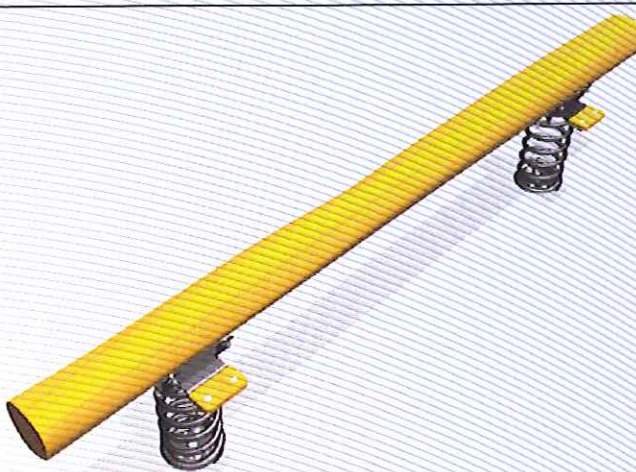

aangewezen bij ministeriële beschikking van 4 mei 2012, nr. VGP 3113590
commissioned by departmental order of 4 May 2012, no. VGP 3113590

Certificaat nr. Certificate nr.	032684TA_20130207	Dossiennr. File nr.	032684TA
Productomschrijving Product description	Veerbalk		
Evt. nadere aanduidingen Further indications	Robinia		
voor nadere informatie zie bijbehorend rapport met gelijkloidend dossiernr. for further information see associated report with identical file nr.			
Eigenaar / certificaathouder en adres Owner/certificate holder and address	Boer Speeltoestellen B.V. Hyacintstraat 2 4255 HX Nieuwendijk		
Soort toestel Category of equipment	Speeltoestel / Playground equipment		
Fabrikant Manufacturer	Boer Speeltoestellen B.V. Hyacintstraat 2 4255 HX Nieuwendijk		
Type/Serienummer Type/Serial number	PST.000.145 /		in te vullen door de fabrikant to be filled out by the manufacturer
Jaar van fabricage Year of construction	vanaf 2012 since		
Leverancier Supplier	Boer Speeltoestellen B.V. Hyacintstraat 2 4255 HX Nieuwendijk		
Jaar van leverantie Year of supply	in te vullen door de leverancier to be filled out by the supplier		
Datum keuring Date of examination	22-01-2013 – 07-02-2013		

TÜV Nederland QA BV, de Waal 21C, NL-5684 PH Best verklaart, dat het bovenaangehaalde toestel voldoet aan de vervaardigingvoorschriften genoemd in het Warenwetbesluit attractie- en speeltoestellen (met als leidraad de normatieve documenten NEN-EN 1176:2008).

TÜV Nederland QA BV declares that the here above mentioned equipment meets the safety and health requirements mentioned in the Dutch law "Warenwetbesluit attractie- en speeltoestellen" (guided by normative documents EN 1176:2008).

Namens het bestuur, For the board, A.C. Boon Directeur	
---------------------------------------------------------------------	--------------------------------------------------------------------------------------

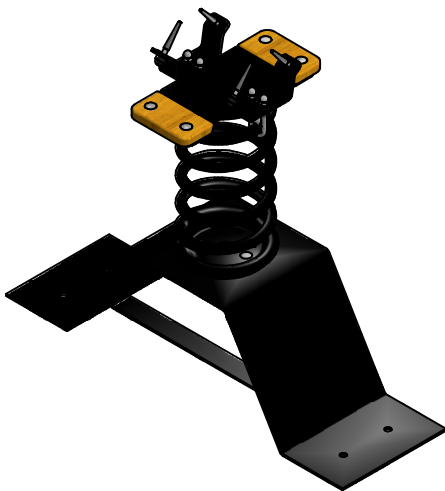
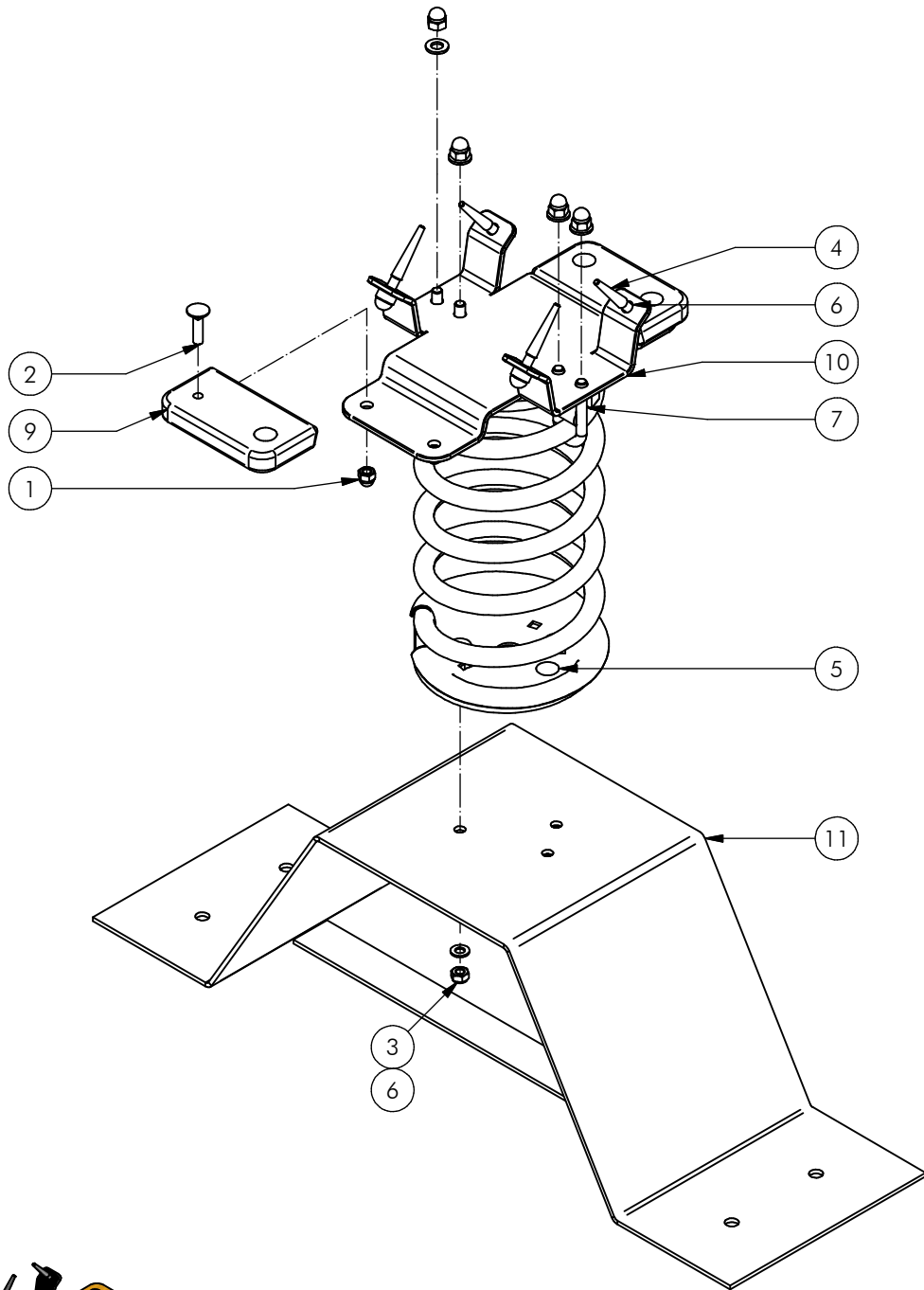

Nr	#	Type	Progr.	Volgnr	Bew.	Rev.	Benaming	Opmerking
1	4	BSR	011	010	020		Borgdopmoer	M10 - RVS A2-70
2	4	BSR	026	010	040		Slotbout	M10 x 40 - RVS A2-70
3	3	BSV	010	010	010		Borgmoer	M10 - VZ 8.8
4	4	BSV	022	010	080		Houtdraadbout	M10 X 80 - VZ 8.8
5	3	BSV	026	010	035		Slotbout	M10 x 35 - VZ 8.8
6	7	BSV	030	010	002		Sluitring	M10 - VZ 8.8
7	1	DRD	ELB	020	003		Veer 40 cm	Schotel en U-bouten
8	4	KST	DOP	010	021		Afdekdop zeskantbout	M10 zwart
9	2	OHO	PST	310	001		Voetsteun	Veelement
10	1	OME	PST	047	372	A	Veerplaat	met voetsteun
11	1	SME	MNP	016	372		grondanker	veerwip



Benaming
Title: Veerstier

Opmerking
Comment: Onderstel

Datum
Date: 6-3-2012

Tekening
Drawing

MOD PST 006 029

Samenstelling module Assembly module



1

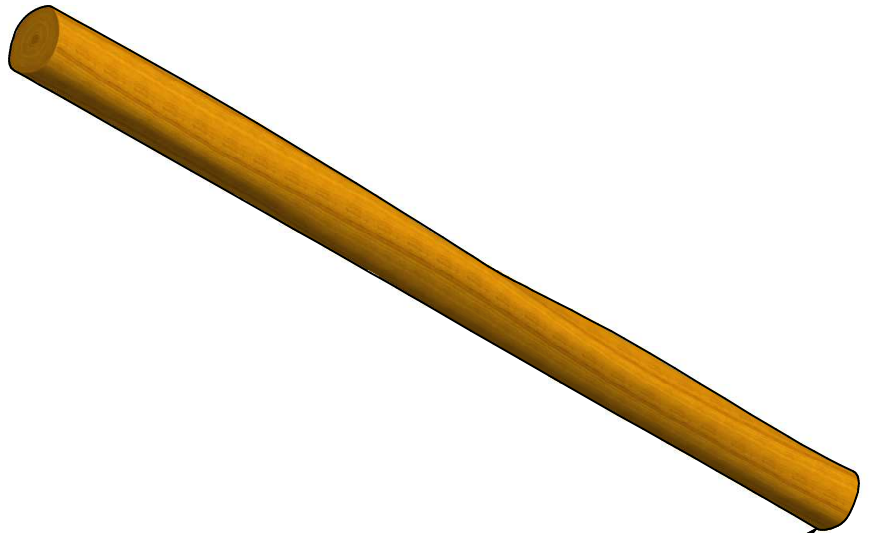

Beide uiteinden afronden R>3 mm

Nr	#	Type	Progr.	Volgnr	Bew.	Rev.	Benaming	Opmerking
1	1	OHO	PST	200	030		Paal 18-20	Lengte =3000



Benaming
Title Veerbalk

Opmerking
Comment Adventure Play

Datum
Date 19-12-2011

Tekening
Drawing

MOD PST 006 031

Samenstelling module Assembly module